

R5 Fixing LIB rafters joining over a wall

Fix rafter to supports
in accordance with
Detail R1

LIB rafter joint detail
300x25mm strap with
6/30x3.15 nails to
each rafter

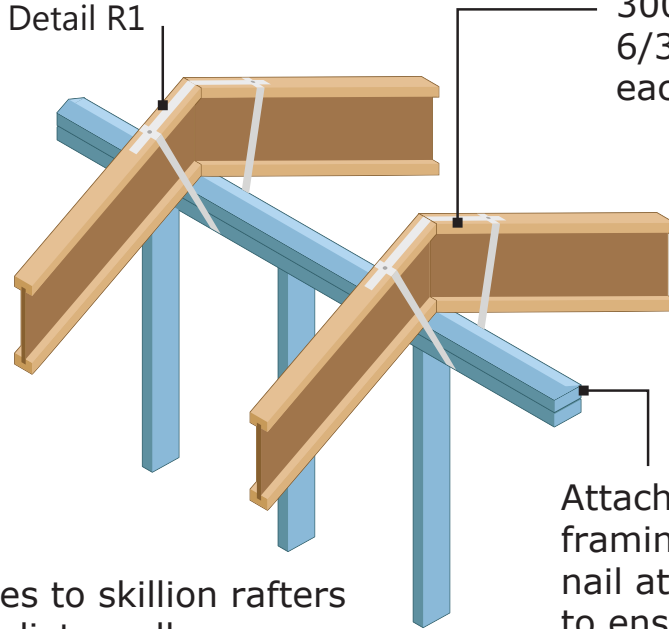

Attach bevelled plate to
framing with 1/90x3.15
nail at 400mm centres
to ensure correct rafter
bearing

Same fixing applies to skillion rafters
joined on intermediate wall